

# Palladian™ 6, 8, and 10-Panel Set-Up Instructions

The 6, 8, and 10-panel Palladian displays (pictured below) are assembled much like the 12-panel display described on the reverse side. There are fewer panels, but the same panel/guide system of assembly is used. Top and bottom panel sections may also be used separately as tabletop displays.

Palladian 6-Panel

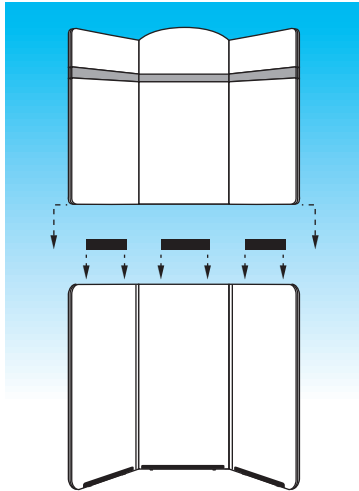

Palladian 8-Panel

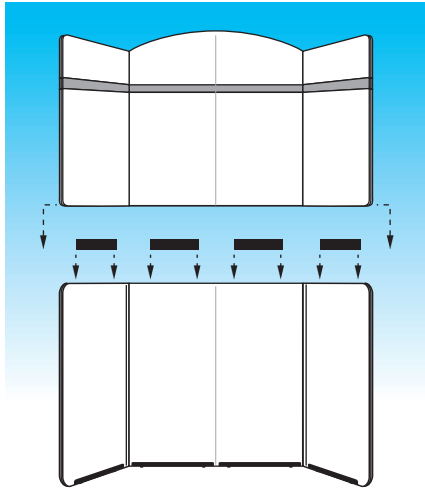

Palladian 10-Panel

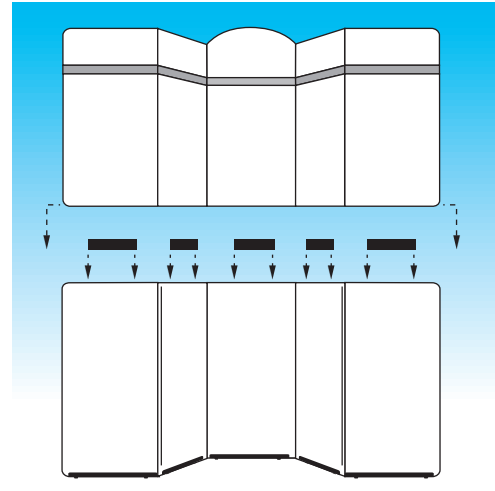

## Curve Panel Set Up Instructions

Patent applied for

1

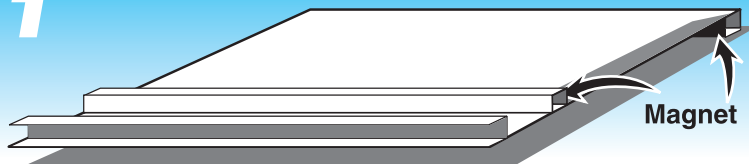

Place curve on flat surface, fabric side down, facing large "U" channel.

2

Roll far edge of panel forward, creating a tube shape. Align aluminum bars with magnets and allow bars to "snap" together to complete curved shape.

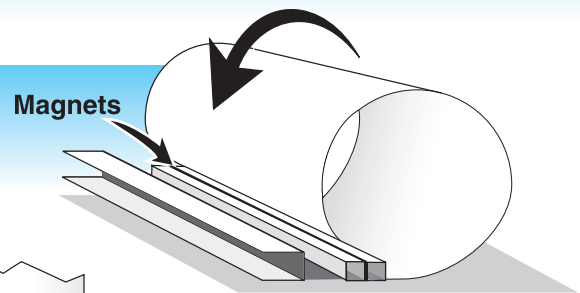

3

Attach curve to side of the display.

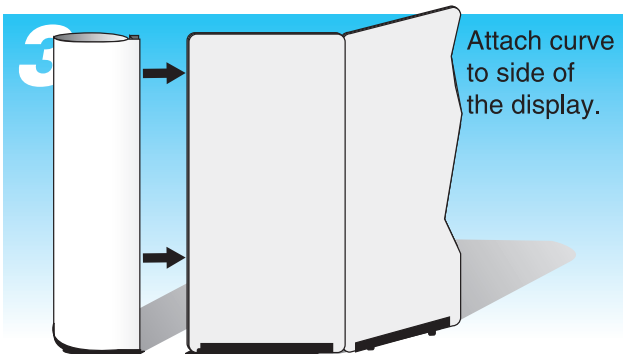

4

Velcro

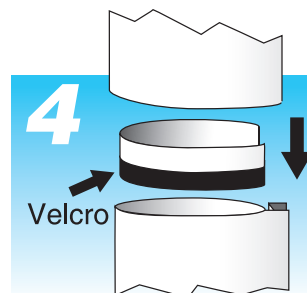

To stack curves on a freestanding display, Velcro flexible stacking guide to inside top of base curve. Slide top curve over guide to complete.